

CALÇADA EXTERNA ANTIDERRAPANTE
A: 26,21 m²

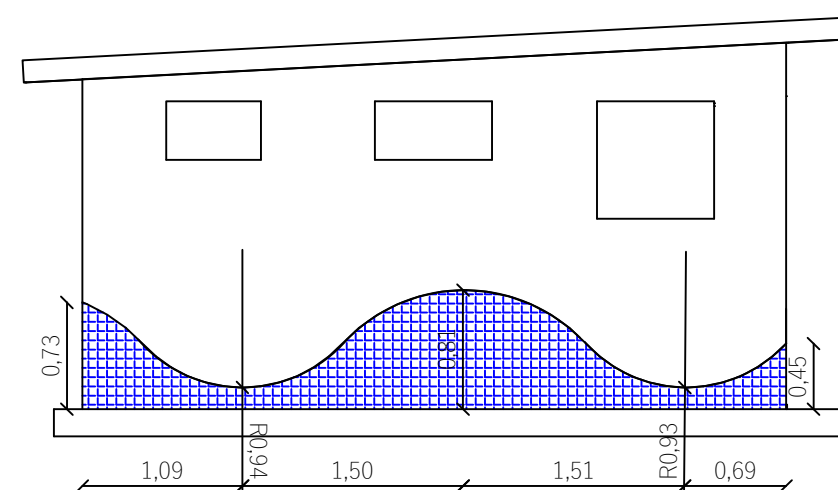

Fachada lateral esquerda

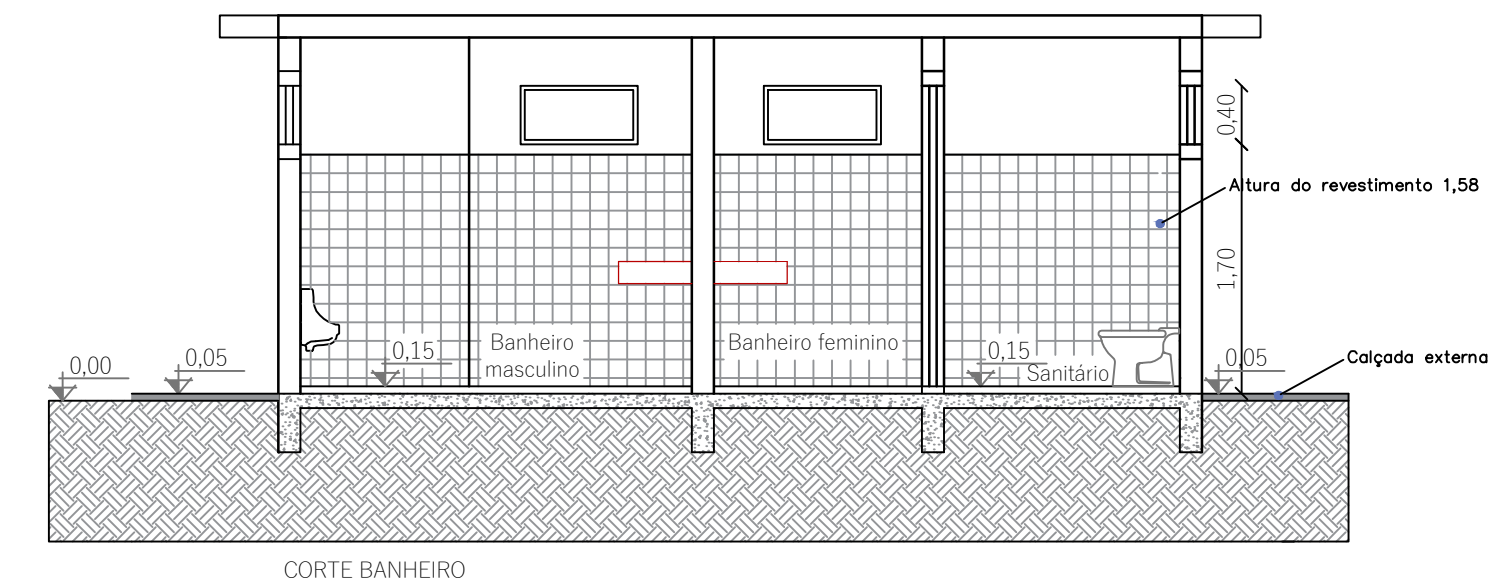
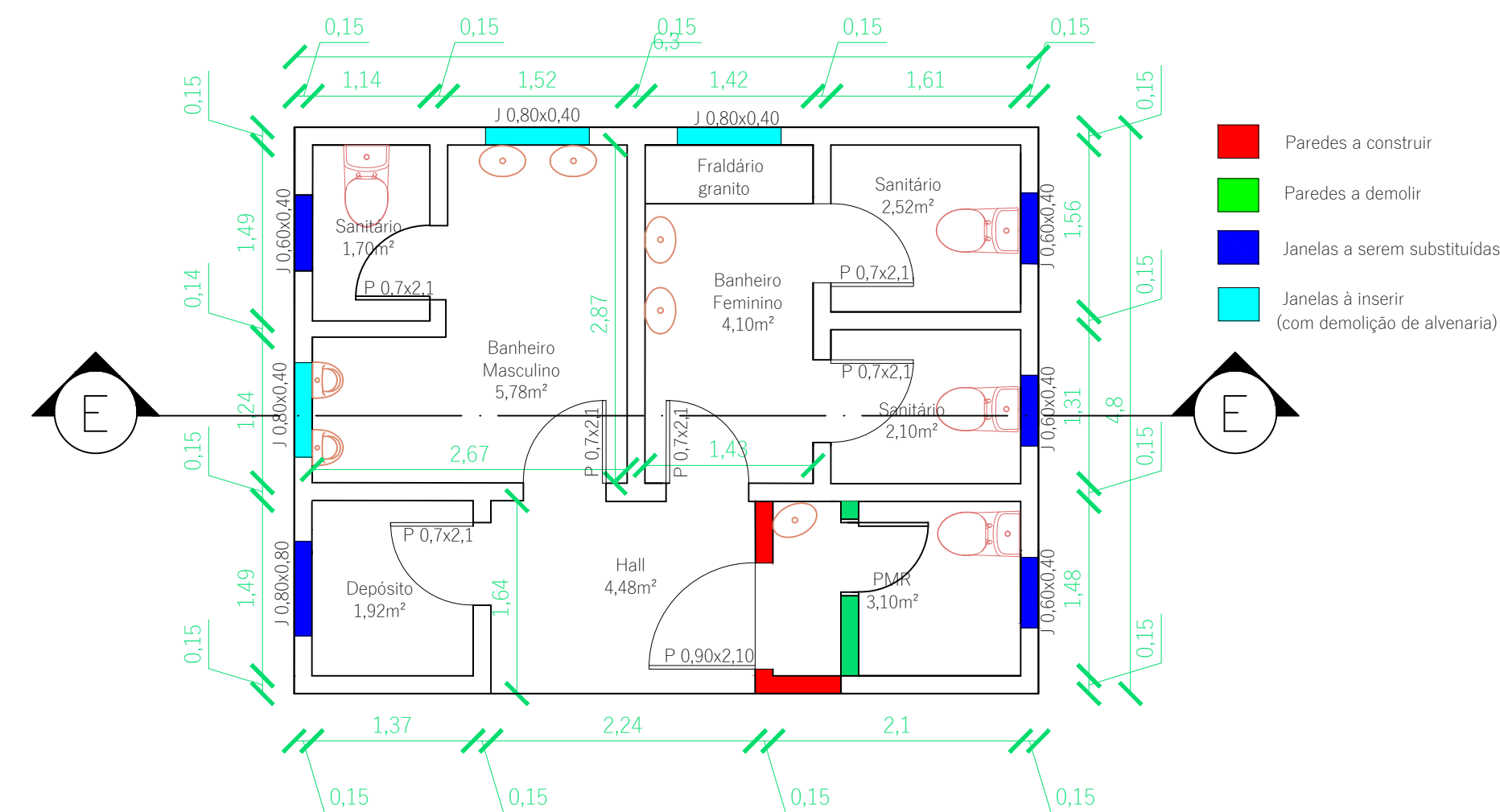
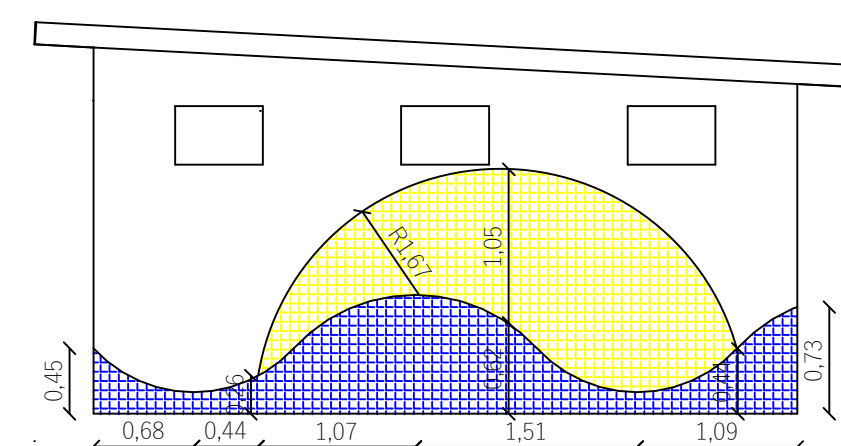

Fachada lateral direita

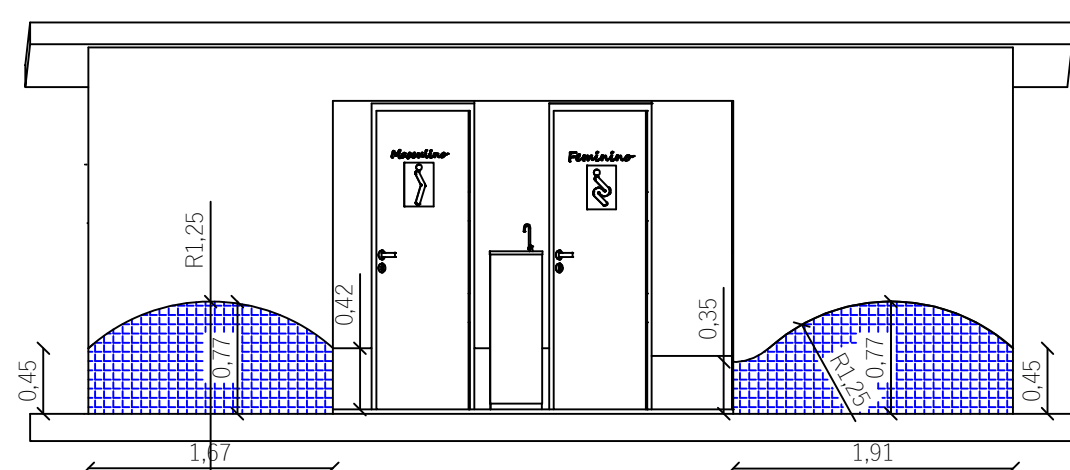

Fachada Frontal

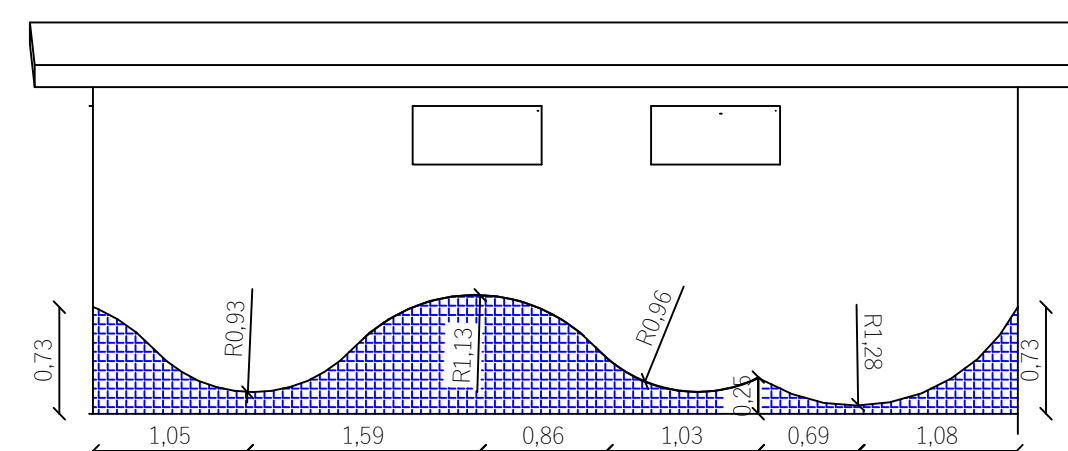

Fachada Posterior

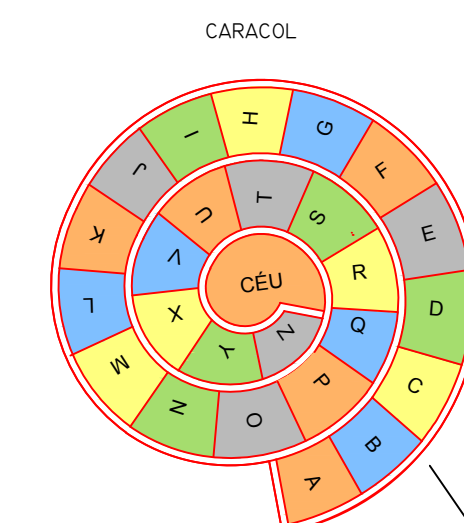
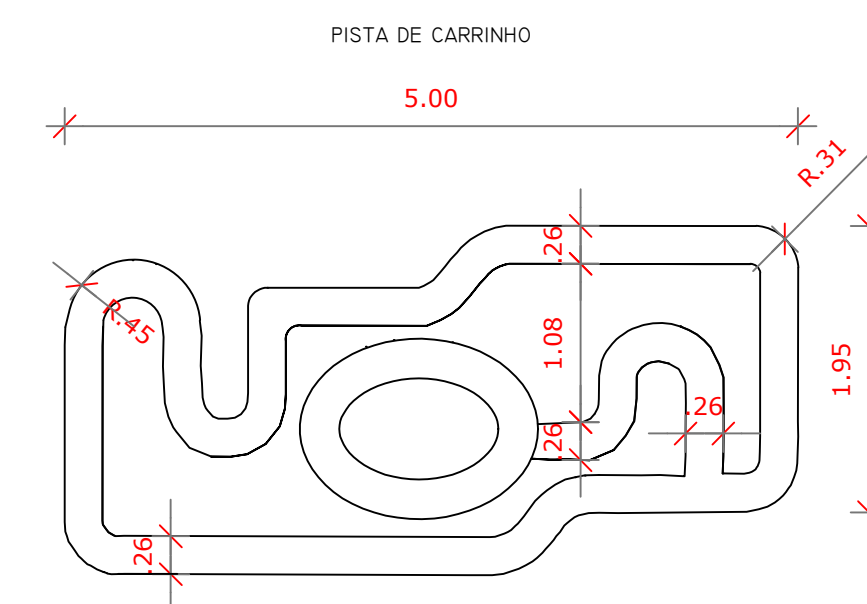

PINTURA EPOXI NAS CORES:
AMARELA, AZUL, CINZA,
VERDE E LARANJA.
TEXTO NA COR PRETA

AMARELINHA COM BLOCOS INTERTRAVADO DE CONCRETO

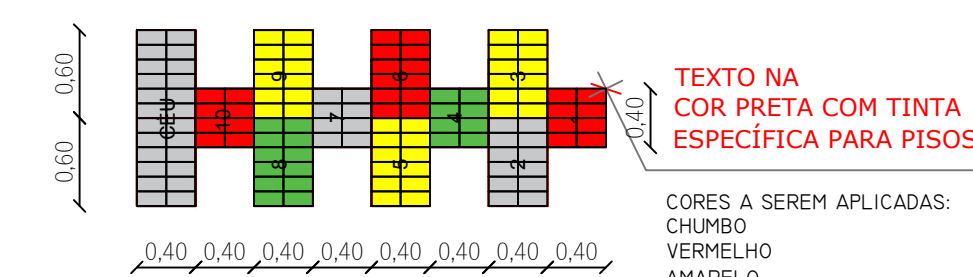

TEXTO NA
COR PRETA COM TINTA
ESPECÍFICA PARA PISOS

CORES A SEREM APLICADAS:
CHUMBO
VERMELHO
AMARELO
VERDE

BICICLETÁRIO

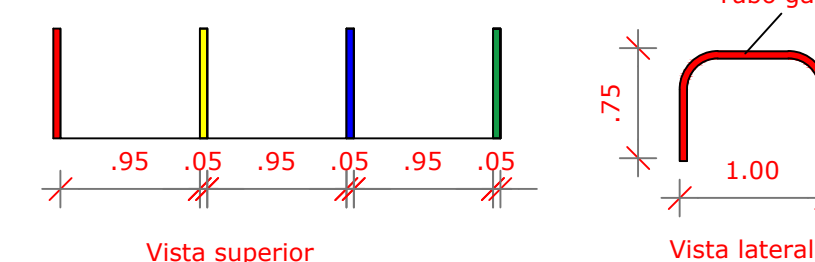

Tubo galvanizado 50 mm

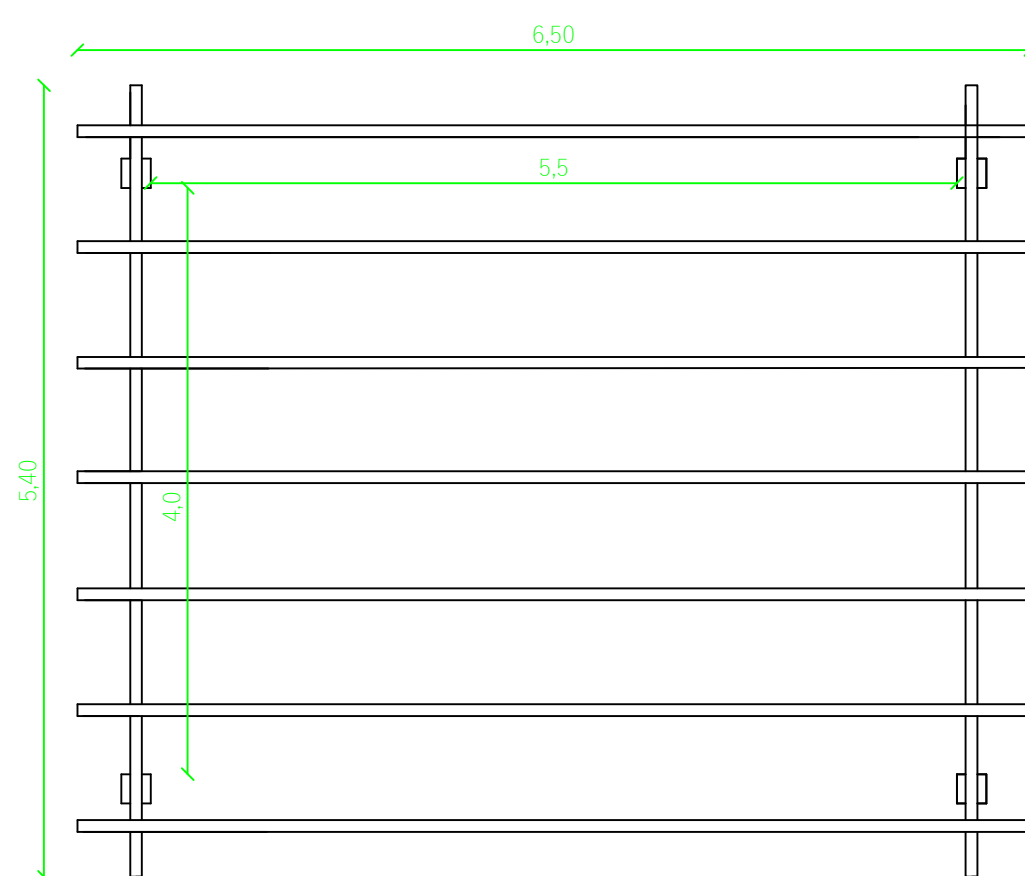

Vista superior

Pergolado de madeira garapeira ou itaúba
peças parafusadas

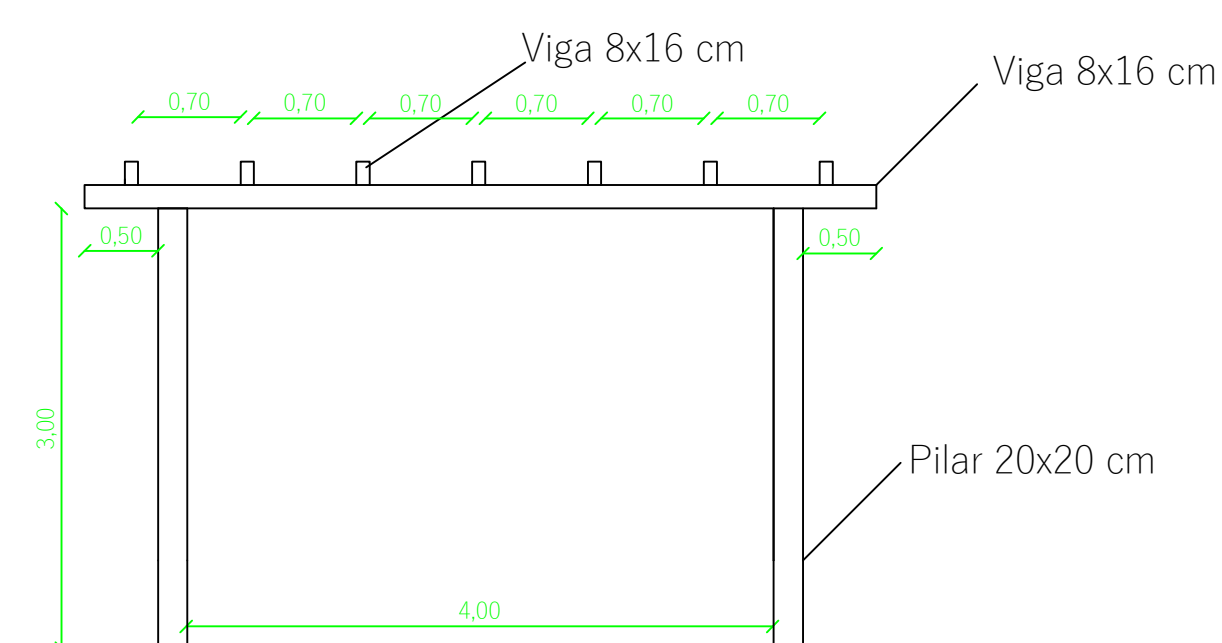

Vista frontal

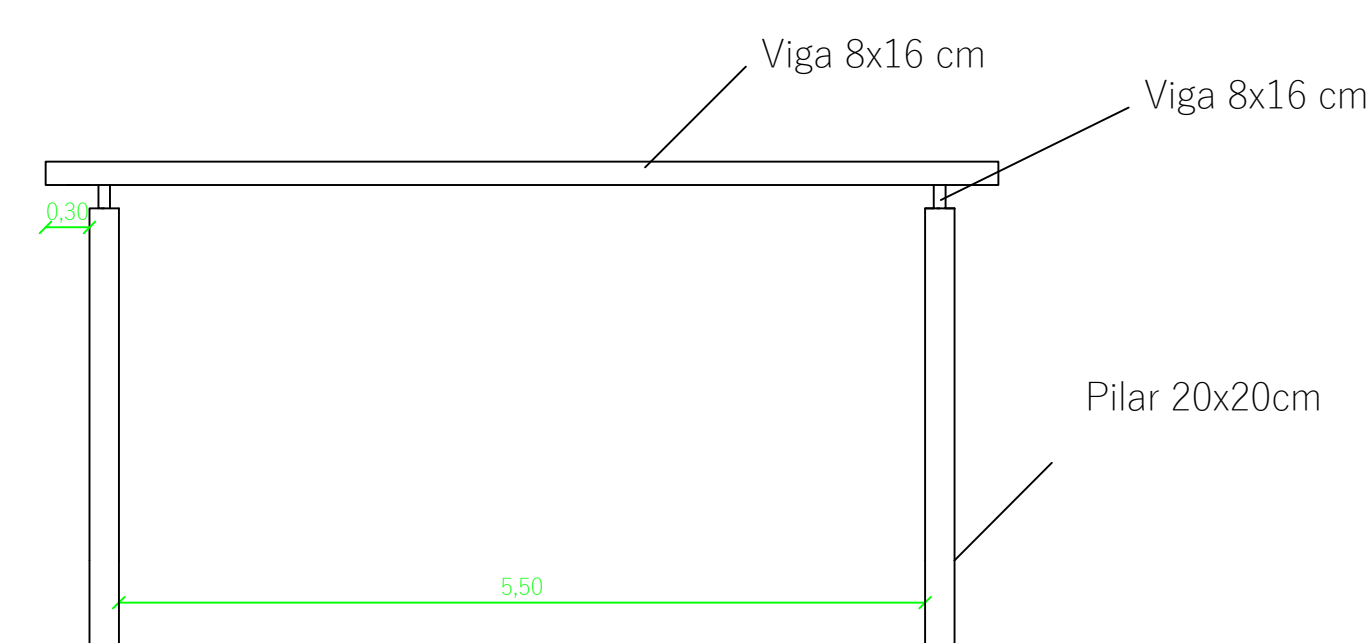

Vista lateral

| | |
|---|---------------------------------|
|  | |
| DEPARTAMENTO MUNICIPAL DE ENGENHARIA | |
| PREFEITURA MUNICIPAL DE TENENTE PORTELA | |
| PROJETO DE REFORMA DA PRAÇA ALIBINO RIGON | ÁREA CONSTRUÍDA: 2.567,11 m² |
| DETALHAMENTOS | DATA: DEZEMBRO/2019 |
| Colaboração: FERNANDA HERMES SOARES E JACKSON JORGE BITENCORTE | |
| Engenheiro Civil | REGISTRO CREA: 180283 |
| ESCALA: S/E | FRANCHA: 09/11 |
| Resp. Técnico | Prefeito Municipal |